

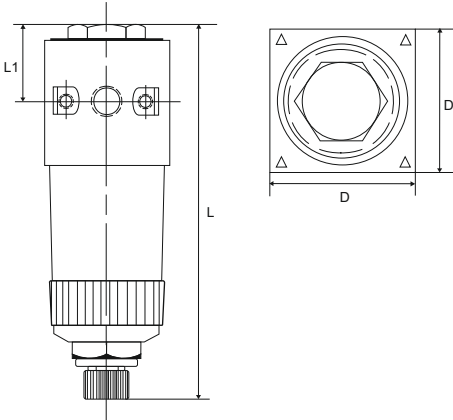

FILTER 2018

Water separator, Spin-on filter,
Filter and Silencer

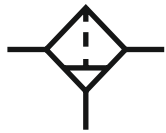

■ WATER SEPERATOR / FILTER

Material

Housing material: Zinc die-cast, blue (Z410)
 Condensate container: Polycarbonate
 O-Ring: NBR
 Sinter filter: 50µm

Technical Data

Operatur pressure: max. 16 bar
 Nominal pressure (housing): PN 25
 Nominal flow: 1170 l/min
 Mediums temperature: max. 50°C
 Ambient temperature: max. 50°C
 Tank volume: 10 cm
 Installation position: vertical/arrow direction
 Emptying: manuell
 Weight: 230 g

Order Data

| Art. No. | Thread IG | Manometer Connection IG | L mm | L1 mm | D mm |
|------------|-----------|-------------------------|-------|-------|------|
| LHF022.B01 | 2x 1/4" | 2x 1/8" | 120,0 | 25,0 | 40,0 |

Accessories

| Art. No. | Description |
|-----------------------------|--------------------------------|
| Filter | |
| LHF022.001 | 50 µm (Standard) |
| LHF022.002 | 10 µm |
| Mounting bracket-Set | |
| BHB022.001 | Mounting bracket with 2 screws |
| LHF022.B02 | Plastic container with O-Ring |



Filter 50µm



Mounting bracket with 2 screws



Plastic container with O-Ring

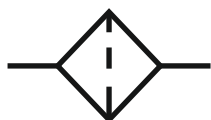

■ SPIN - ON FILTER

Material

Housing material: Polyamid 6
 Colour: transparent

Technical Data

Temperature in operation: up to 50°C
 Temperature short-term: up to 120°C
 Pressure max. up to 6 bar
 Filtering: 12 µm

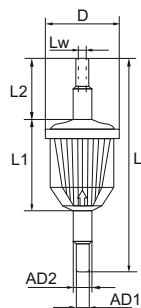

Order Data

| Art. No. | Connection nozzle | | Lw mm | L mm | L1 mm | L2 mm | D mm | Material Filter |
|-------------|-------------------|---------|-------|-------|-------|-------|------|-----------------|
| | ØAD1 mm | ØAD2 mm | | | | | | |
| LHF0100.000 | 6 | 8 | 4 | 107,0 | 45,0 | 31,0 | 36,0 | Paper |

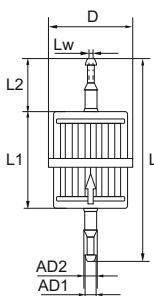

Order Data

| Art. No. | Connection nozzle | | Lw mm | L mm | L1 mm | L2 mm | D mm | Material Filter |
|-------------|-------------------|---------|-------|-------|-------|-------|------|-----------------|
| | ØAD1 mm | ØAD2 mm | | | | | | |
| LHF0100.010 | 6 | 8 | 4 | 118,0 | 55,0 | 31,5 | 48,0 | Paper/Sheet |

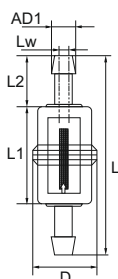

Order Data

| Art. No. | Connection nozzle | | Lw mm | L mm | L1 mm | L2 mm | D mm | Material Filter |
|-------------|-------------------|--|-------|------|-------|-------|------|-----------------|
| | ØAD1 mm | | | | | | | |
| LHF0100.020 | 6 | | 3 | 59,0 | 29,0 | 15,0 | 19,0 | Nylon |

■ SPIN - ON FILTER

Material

Housing material: PS
 Filter designator: Viledon

Technical Data

Temperature resistance: <70°C

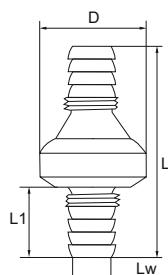

Order Data

| Art. No. | | Lw mm | L mm | L1 mm | D mm |
|----------|--|-------|------|-------|------|
| | | | | | |

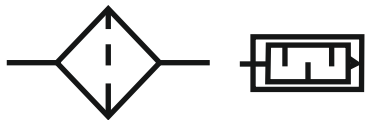

■ SILENCER / FILTER

Material

Housing material: Plastic
 Fill: Felt
 Colour: black

Application

Silencer/Filter with outside thread connector.
 Suitable for direct installation at the cylinder head by compressor and vacuum pumps.

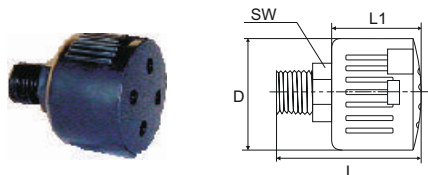

Order Data

| Art. No. | Thread AG | L mm | L1 mm | D mm | SW |
|-------------|-----------|------|-------|------|----|
| UHQ2750.230 | 1/4" | 45,0 | 27,0 | 35,0 | 17 |

■ SILENCER / FILTER

Material

Housing material: Aluminium
 Fill: Felt
 Colour: black

Application

With vacuum as a filter and with pressure usable as a silencer.
 On pumps with tube connector the filter is connected with a piece of silicon tubing.
 Suitable for pumps and compressors up to 30 l/min.

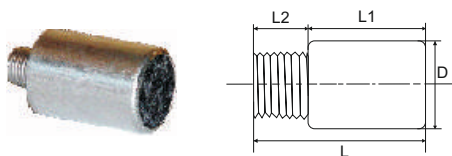

Order Data

| Art. No. | Thread AG | L mm | L1 mm | L2 mm | D mm |
|-------------|-----------|------|-------|-------|------|
| LHF0101.000 | 1/8" | 38,0 | 30,0 | 8,0 | 20,0 |

■ SILENCER / FILTER

Material

Housing material: Vyon and Polyethylene

Technical Data

Operating pressure: max. 10 bar
 Temperature area: -10°C up to +70°C

Application

With vakuüm as a filter and with pressure usable as a silencer.

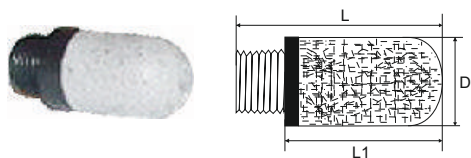

Order Data

| Art. No. | Thread AG | L mm | L1 mm | D mm |
|-------------|-----------|------|-------|------|
| LHF0102.005 | M5 | 20,0 | 17,0 | 7,0 |
| LHF0102.A01 | 1/8" | 28,5 | 23,0 | 13,0 |
| LHF0102.B01 | 1/4" | 34,5 | 28,0 | 17,0 |
| LHF0102.C01 | 3/8" | 63,5 | 53,0 | 25,0 |

■ SILENCER / FILTER

Material

Housing material: Nylon
Colour: black

Technical Data

Operating pressure: 0 up to 8 bar
Temperature area: -10°C up to +60°C

Application

With vacuum as a filter and with pressure usable as a silencer.

Order Data

| Art. No. | Thread AG | L mm | L1 mm | L2 mm | D mm | SW |
|-------------|--------------|---------|----------|----------|---------|----|
| LHF0104.A01 | 1/8" | 33,0 | 27,0 | 6,0 | 15,5 | 10 |
| LHF0104.B01 | 1/4" | 43,0 | 35,0 | 8,0 | 19,5 | 12 |

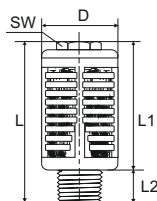

■ SILENCER / FILTER OF SINTERED BRONZE

Material

Material: Sinter bronze

Technical Data

Operating pressure: 0 up to 12 bar
Temperature area: -10°C up to +80°C

Application

With vacuum as a filter and with pressure usable as a silencer.

Order Data

| Art. No. | Thread AG | L mm | L1 mm | L2 mm | D mm | D1 mm |
|------------|--------------|---------|----------|----------|---------|----------|
| LHF0568.A1 | 1/8" | 21,0 | 16,0 | 5,0 | 8,0 | 10,0 |
| LHF0568.B1 | 1/4" | 28,0 | 20,0 | 8,0 | 10,0 | 14,0 |
| LHF0568.C1 | 3/8" | 36,0 | 25,5 | 10,5 | 15,0 | 18,0 |

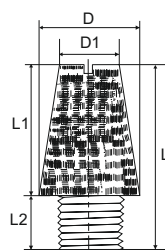

■ SILENCER / FILTER OF SINTERED BRONZE

Material

Material: Sinter bronze, brass

Technical Data

Operating pressure: 0 up to 12 bar
Temperature area: -10°C up to +80°C

Application

With vacuum as a filter and with pressure usable as a silencer.

Order Data

| Art. No. | Thread AG | L mm | L1 mm | | SW |
|------------|--------------|---------|----------|--|----|
| LHF0569.M5 | M5 | 8,0 | 3,5 | | 8 |
| LHF0569.A | 1/8" | 13,0 | 6,0 | | 13 |
| LHF0569.B | 1/4" | 16,0 | 8,0 | | 16 |
| LHF0569.C | 3/8" | 18,0 | 9,0 | | 19 |

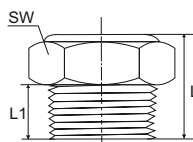

■ CONTACT

If you have any questions or need further information, do not hesitate to contact us

Metzger Technik GmbH & Co. KG
Bertha-Benz-Straße 1
D - 71665 Vaihingen a. d. Enz

Tel. +49 (0) 7042 / 81518 - 0
Fax +49 (0) 7042 / 81518 - 80

Mail: info@metzger-technik.de

